

idealair
group

***JETFLOW &
JETFLOW SILENT***

In-line
mixed
flow fans



SJMF

SJMF100
SJMF125
SJMF150
SJMF200
SJMF250
SJMF315
SJMF355

SJMF-S

SJMF150-S
SJMF200-S
SJMF250-S
SJMF315-S

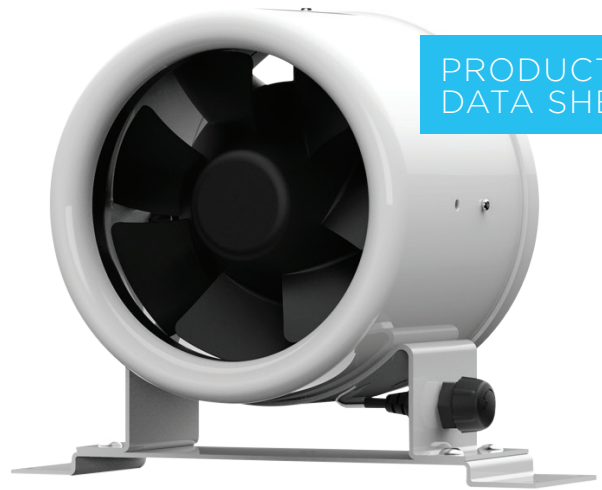

JETFLOW IN-LINE MIXED FLOW FAN

The Jetflow in-line mixed flow fan includes an energy efficient EC motor for low power consumption. It features a steel casing and a 3 metre detachable lead for connection to a remote potentiometer.

Quick Facts

- 7 standard sizes from 100mm to 355mm
- Air volume flow rates up to 1.240 m³/s
- Static pressures up to 548 Pa
- Suitable for operating temperatures up to +60
- Light weight galvanised sheet steel casing
- Comes with sturdy mounting foot
- Comes with energy efficient EC motor

Construction

Casing manufactured from aluminium or cold rolled steel sheet, dependent on size.

Motor

Brushless EC motors are fitted as standard. The IPX4 motor contains sealed for life heavy duty NWB bearings. All motors are suitable for use in ambient air conditions up to +60°C.

Impeller

A high efficiency jet design double mixed flow impeller integrated and directly driven by an EC motor.

Electrical Connection

Electrical connection via 1.5 metre mains lead with 3-pin plug.

Control

Supplied suitable for fixed speed operation. A detachable 3 metre lead with 3.5mm jack connection to the unit is supplied for connection to a remote potentiometer, 0-10VDC or PWM Circuit.

Quality Management

Units are to be designed and manufactured with procedures as defined in BS EN ISO 9001.

Typical Applications

- Shower Rooms
- Bathrooms
- Kitchens
- Laundries
- Utility Rooms
- Residential and Commercial

Performance, SFP & Electrical Data

Product Code	Control Voltage V	Speed r/min	Airflow SFP	Airflow m³/s @ Static Pressure Pa												At Best Efficiency Point		Electrical Data		dBA @ 3m	
				0	25	50	75	100	150	200	250	300	350	400	500	Overall Eff %	Input kW	Peak Amps			
SJMF100	10	5000	m³/s	0.067	0.063	0.059	0.054	0.048	0.036	0.020	-	-	-	-	-	32.1	0.021	0.24	Inlet	46	
			W/(L/s)	0.31	0.33	0.36	0.40	0.45	0.57	0.94	-	-	-	-	-				Outlet	47	
	7.5	3750	m³/s	0.059	0.053	0.048	0.041	0.034	0.015	-	-	-	-	-	-	29.5	0.015	0.18	Inlet	42	
			W/(L/s)	0.25	0.27	0.31	0.36	0.42	0.87	-	-	-	-	-	Outlet				43		
	5	2500	m³/s	0.043	0.036	0.028	0.017	-	-	-	-	-	-	-	-	24.9	0.007	0.09	Inlet	36	
			W/(L/s)	0.17	0.21	0.27	0.40	-	-	-	-	-	-	-	Outlet				36		
SJMF125	10	5000	m³/s	0.080	0.077	0.074	0.071	0.068	0.059	0.047	-	-	-	-	-	42.7	0.027	0.26	Inlet	47	
			W/(L/s)	0.30	0.32	0.33	0.36	0.38	0.45	0.56	-	-	-	-	Outlet				48		
	7.5	3750	m³/s	0.069	0.066	0.062	0.058	0.053	0.040	-	-	-	-	-	41.9	0.018	0.18	Inlet	43		
			W/(L/s)	0.21	0.24	0.27	0.30	0.34	0.43	-	-	-	-	-				Outlet	44		
	5	2500	m³/s	0.051	0.046	0.041	0.032	-	-	-	-	-	-	-	-	34.4	0.009	0.09	Inlet	37	
			W/(L/s)	0.15	0.17	0.21	0.27	-	-	-	-	-	-	-	Outlet				37		
SJMF150	10	4980	m³/s	0.144	0.141	0.137	0.134	0.130	0.121	0.110	0.094	-	-	-	-	61.0	0.049	0.39	Inlet	50	
			W/(L/s)	0.28	0.30	0.32	0.34	0.36	0.40	0.44	0.52	-	-	-	Outlet				51		
	7.5	4245	m³/s	0.123	0.119	0.115	0.111	0.106	0.094	0.074	-	-	-	-	-	62.2	0.031	0.30	Inlet	46	
			W/(L/s)	0.20	0.23	0.25	0.27	0.29	0.33	0.41	-	-	-	-	Outlet				47		
	5	3195	m³/s	0.092	0.087	0.080	0.072	0.059	-	-	-	-	-	-	-	50.7	0.015	0.13	Inlet	40	
			W/(L/s)	0.15	0.16	0.18	0.21	0.26	-	-	-	-	-	-	Outlet				40		
SJMF200	10	3740	m³/s	0.269	0.266	0.262	0.257	0.253	0.242	0.229	0.211	0.180	-	-	-	64.9	0.100	0.79	Inlet	51	
			W/(L/s)	0.28	0.29	0.30	0.31	0.33	0.37	0.42	0.47	0.54	-	-	-				Outlet	52	
	7.5	3225	m³/s	0.232	0.227	0.221	0.215	0.208	0.191	0.162	0.110	-	-	-	-	61.5	0.060	0.59	Inlet	48	
			W/(L/s)	0.18	0.21	0.23	0.25	0.28	0.32	0.38	0.50	-	-	-	-				Outlet	49	
	5	2505	m³/s	0.179	0.172	0.164	0.153	0.136	-	-	-	-	-	-	-	58.0	0.030	0.25	Inlet	43	
			W/(L/s)	0.13	0.15	0.17	0.19	0.22	-	-	-	-	-	-	-				Outlet	43	
SJMF250	10	3195	m³/s	0.446	0.442	0.437	0.432	0.427	0.412	0.390	0.360	0.322	-	-	-	64.6	0.172	1.30	Inlet	55	
			W/(L/s)	0.29	0.30	0.31	0.33	0.34	0.38	0.42	0.47	0.53	-	-	-				Outlet	56	
	7.5	2725	m³/s	0.382	0.377	0.371	0.364	0.355	0.330	0.293	0.250	-	-	-	-	68.1	0.106	0.98	Inlet	51	
			W/(L/s)	0.21	0.22	0.24	0.25	0.27	0.31	0.36	0.43	-	-	-	-				Outlet	52	
	5	2040	m³/s	0.282	0.273	0.261	0.245	0.222	-	-	-	-	-	-	-	68.1	0.045	0.36	Inlet	45	
			W/(L/s)	0.13	0.14	0.16	0.18	0.20	-	-	-	-	-	-	-				Outlet	45	
SJMF315	10	3000	m³/s	0.815	0.806	0.796	0.785	0.773	0.741	0.694	0.633	0.569	0.508	0.440	-	57.9	0.375	2.71	Inlet	62	
			W/(L/s)	0.37	0.39	0.41	0.43	0.45	0.50	0.55	0.61	0.66	0.74	0.85	-				Outlet	62	
	7.5	2600	m³/s	0.715	0.695	0.675	0.655	0.634	0.589	0.539	0.480	0.401	-	-	-	58.5	0.254	1.96	Inlet	58	
			W/(L/s)	0.30	0.32	0.34	0.36	0.38	0.42	0.47	0.53	0.63	-	-	-				Outlet	58	
	5	1950	m³/s	0.537	0.506	0.476	0.445	0.414	0.346	-	-	-	-	-	-	58.5	0.111	0.91	Inlet	52	
			W/(L/s)	0.18	0.20	0.22	0.24	0.26	0.32	-	-	-	-	-	-				Outlet	52	
SJMF355	10	3000	m³/s	1.240	1.210	1.190	1.170	1.140	1.090	1.040	0.980	0.912	0.835	0.742	0.477	67.6	0.538	3.80	Inlet	64	
			W/(L/s)	0.43	0.44	0.45	0.46	0.47	0.49	0.51	0.55	0.59	0.64	0.72	1.12				Outlet	66	
	7.5	2655	m³/s	1.090	1.060	1.040	1.010	0.989	0.927	0.856	0.773	0.674	0.553	0.392	-	66.4	0.376	2.73	Inlet	62	
			W/(L/s)	0.34	0.35	0.36	0.37	0.38	0.40	0.44	0.49	0.56	0.68	0.96	-				Outlet	63	
	5	1930	m³/s	0.800	0.768	0.731	0.690	0.643	0.533	0.393	-	-	-	-	-	63.2	0.162	1.26	Inlet	56	
			W/(L/s)	0.20	0.21	0.22	0.23	0.25	0.30	0.41	-	-	-	-	-				Outlet	57	

Data provided is at standard air density of 1.2 kg/m³.

Measurement category used to determine energy efficiency: D.

A variable speed drive is integrated within the fan.

Peak Amps @ 230V / 1PH / 50Hz.

The overall A-weighted sound pressure level is at a distance of 3m with spherical free-field propagation. It is expressed in dB re-20QPa and is presented for comparative purposes only.

Suitable for operation from 2V control signal. For performance, refer to our selection software.

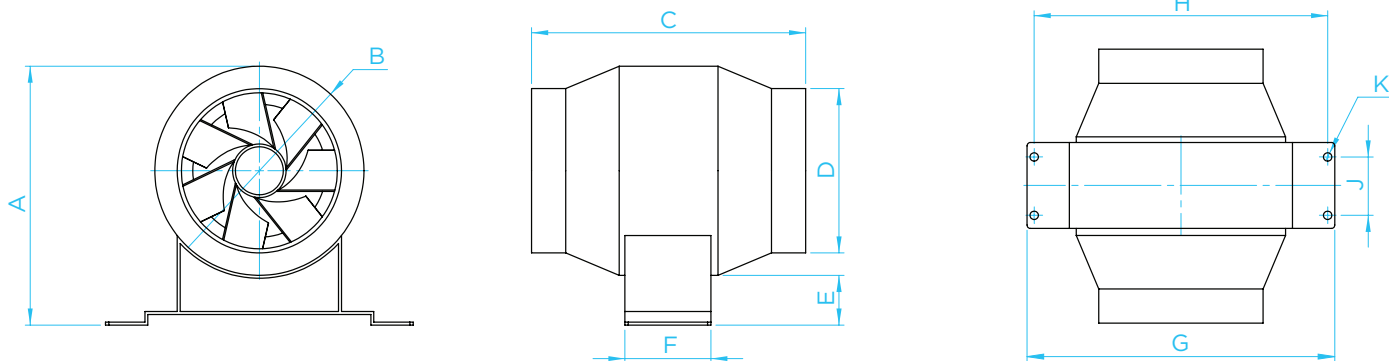

Dimensional Data

Product Code	A	B	C	D	E	F	G	H	J	K	Weight kg
SJMF100	150	125	159	98	25	51	184	175	37	5	1.1
SJMF125	151	126	110	124	26	51	184	175	37	5	1.1
SJMF150	173	153	165	150	21	80	187	175	37	5 x 8 SLOT	1.6
SJMF200	223	203	220	200	22	105	221	210	39	5 x 8 SLOT	2.6
SJMF250	274	254	210	250	22	105	300	288	26	5 x 8 SLOT	3.7
SJMF315	356	317	290	313	39	164	360	336	68	9 x 14 SLOT	8.5
SJMF355	401	358	330	353	45	184	405	380	77	9 x 14 SLOT	12.0

Performance Data

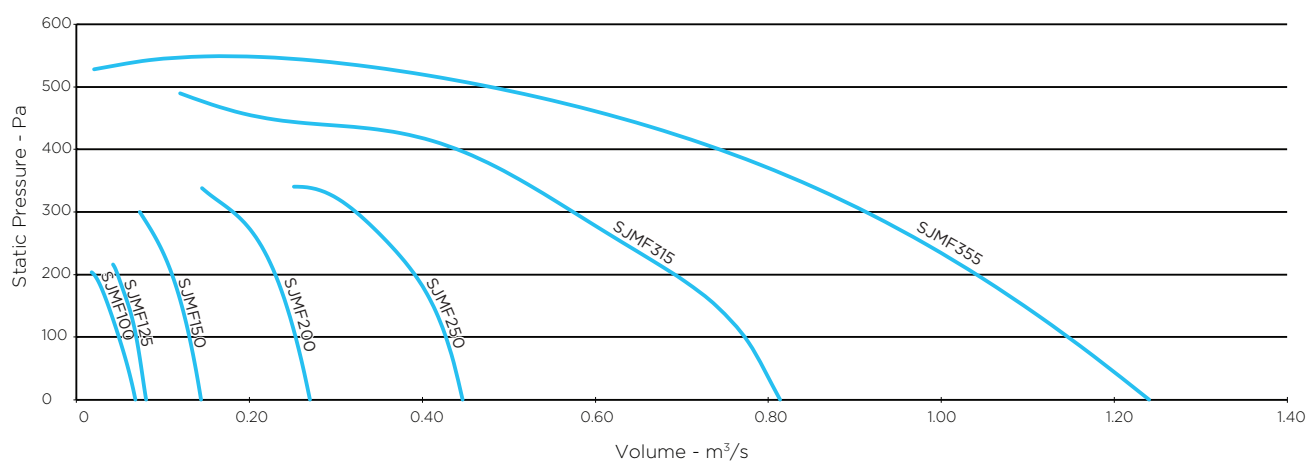



JETFLOW SILENT IN-LINE MIXED FLOW FAN

The Jetflow Silent in-line mixed flow fan includes an energy efficient EC motor for low power consumption. It features a steel casing and a 3 metre detachable lead for connection to a remote potentiometer.

Quick Facts

- 4 standard sizes from 150mm to 315mm
- Total air volume flow rates up to 0.793 m³/s
- Static pressures up to 434 Pa
- Suitable for operating temperatures up to +60
- Acoustic design for low noise levels
- Comes with energy efficient EC motor

Acoustic Enclosure

For reduced noise levels.

Construction

Casing manufactured from aluminium or cold rolled steel sheet, dependent on size.

Motor

Brushless EC motors are fitted as standard. The IPX4 motor contains sealed for life heavy duty NWB bearings. All motors are suitable for use in ambient air conditions up to +60°C.

Impeller

A high efficiency jet design double mixed flow impeller integrated and directly driven by an EC motor.

Electrical Connection

Electrical connection via 1.5 metre mains lead with 3-pin plug.

Control

Supplied suitable for fixed speed operation. A detachable 3 metre lead with 3.5mm jack connection to the unit is supplied for connection to a remote potentiometer, 0-10VDC or PWM Circuit.

Quality Management

Units are to be designed and manufactured with procedures as defined in BS EN ISO 9001.

Typical Applications

- Shower Rooms
- Bathrooms
- Kitchens
- Laundries
- Utility Rooms
- Residential and Commercial

Performance, SFP & Electrical Data

Product Code	Control Voltage V	Speed r/min	Airflow SFP	Airflow m ³ /s @ Static Pressure Pa											At Best Efficiency Point		Electrical Data	dBA @ 3m	
				0	25	50	75	100	150	200	250	300	350	400	Overall Eff %	Input kW	Peak Amps		
SJMF150-S	10	4900	m ³ /s	0.145	0.140	0.136	0.132	0.127	0.116	0.102	0.082	0.043	-	-	53.6	0.050	0.39	Inlet	40
			W/(L/s)	0.28	0.30	0.32	0.34	0.37	0.42	0.49	0.60	0.96	-	-				Outlet	40
	7.5	4245	m ³ /s	0.123	0.118	0.113	0.107	0.101	0.086	0.058	-	-	-	-	45.1	0.032	0.31	Inlet	38
			W/(L/s)	0.21	0.23	0.25	0.27	0.30	0.37	0.51	-	-	-	-				Outlet	38
	5	3195	m ³ /s	0.092	0.085	0.077	0.067	0.054	-	-	-	-	-	-	45.8	0.015	0.13	Inlet	32
			W/(L/s)	0.14	0.16	0.19	0.23	0.28	-	-	-	-	-	-				Outlet	33
			m ³ /s	0.14	0.16	0.19	0.23	0.28	-	-	-	-	-	-				Breakout	19
			W/(L/s)	0.14	0.16	0.19	0.23	0.28	-	-	-	-	-	-				Breakout	19
SJMF200-S	10	3730	m ³ /s	0.269	0.263	0.258	0.253	0.248	0.237	0.223	0.206	0.178	-	-	67.4	0.099	0.77	Inlet	40
			W/(L/s)	0.26	0.28	0.30	0.32	0.34	0.38	0.42	0.48	0.56	-	-				Outlet	42
	7.5	3205	m ³ /s	0.231	0.224	0.216	0.209	0.202	0.187	0.168	-	-	-	-	57.0	0.065	0.60	Inlet	38
			W/(L/s)	0.19	0.21	0.23	0.25	0.27	0.32	0.38	-	-	-	-				Outlet	40
	5	2495	m ³ /s	0.177	0.168	0.160	0.150	0.138	-	-	-	-	-	-	64.9	0.030	0.24	Inlet	33
			W/(L/s)	0.13	0.14	0.16	0.18	0.21	-	-	-	-	-	-				Outlet	34
			m ³ /s	0.13	0.14	0.16	0.18	0.21	-	-	-	-	-	-				Breakout	20
			W/(L/s)	0.13	0.14	0.16	0.18	0.21	-	-	-	-	-	-				Breakout	20
SJMF250-S	10	3190	m ³ /s	0.442	0.434	0.424	0.414	0.404	0.381	0.353	0.317	0.265	-	-	60.9	0.164	1.24	Inlet	44
			W/(L/s)	0.29	0.31	0.33	0.35	0.36	0.41	0.46	0.52	0.61	-	-				Outlet	48
	7.5	2700	m ³ /s	0.377	0.366	0.354	0.341	0.326	0.293	0.247	-	-	-	-	53.7	0.099	0.95	Inlet	42
			W/(L/s)	0.21	0.23	0.25	0.27	0.29	0.34	0.40	-	-	-	-				Outlet	44
	5	2000	m ³ /s	0.279	0.264	0.246	0.225	0.196	-	-	-	-	-	-	59.7	0.043	0.34	Inlet	36
			W/(L/s)	0.13	0.14	0.16	0.19	0.22	-	-	-	-	-	-				Outlet	36
			m ³ /s	0.13	0.14	0.16	0.19	0.22	-	-	-	-	-	-				Breakout	21
			W/(L/s)	0.13	0.14	0.16	0.19	0.22	-	-	-	-	-	-				Breakout	21
SJMF315-S	10	2970	m ³ /s	0.793	0.786	0.777	0.767	0.756	0.729	0.690	0.635	0.573	0.513	0.445	55.8	0.386	2.73	Inlet	56
			W/(L/s)	0.36	0.38	0.40	0.42	0.45	0.49	0.54	0.60	0.67	0.75	0.86				Outlet	56
	7.5	2580	m ³ /s	0.684	0.675	0.664	0.652	0.638	0.595	0.527	0.458	0.384	-	-	56.9	0.247	1.79	Inlet	53
			W/(L/s)	0.28	0.30	0.32	0.34	0.36	0.41	0.47	0.54	0.64	-	-				Outlet	53
	5	1945	m ³ /s	0.514	0.501	0.483	0.455	0.415	0.329	-	-	-	-	-	57.7	0.106	0.79	Inlet	47
			W/(L/s)	0.16	0.18	0.20	0.22	0.25	0.32	-	-	-	-	-				Outlet	47
			m ³ /s	0.16	0.18	0.20	0.22	0.25	0.32	-	-	-	-	-				Breakout	27
			W/(L/s)	0.16	0.18	0.20	0.22	0.25	0.32	-	-	-	-	-				Breakout	27

Data provided is at standard air density of 1.2 kg/m³.

Measurement category used to determine energy efficiency: D.

A variable speed drive is integrated within the fan.

Peak Amps @ 230V / 1PH / 50Hz.

The overall A-weighted sound pressure level is at a distance of 3m with spherical free-field propagation. It is expressed in dB re-20QPa and is presented for comparative purposes only.

Breakout levels are calculated from the tested inlet and outlet sound power levels using the ASHRAE breakout sound transmission calculation procedure.

Suitable for operation from 2V control signal. For performance, refer to our selection software.

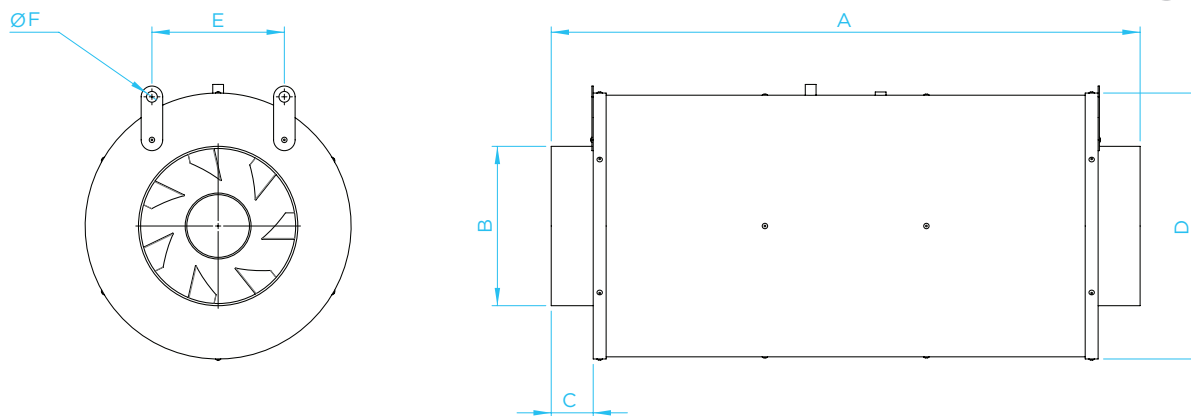

Dimensional Data

Product Code	A	B	C	D	E	F	Weight kg
SJMF150-S	547	148	39	243	123	10	5
SJMF200-S	699	198	40	304	174	10	8
SJMF250-S	859	248	45	353	221	10	14
SJMF315-S	940	313	46	415	268	10	20

Performance Data

